

STANDARD CONSTRUCTION

FRAME: .081" thick (nominal) extruded aluminum 6063-T52/T6 alloy.

BLADE: .081" thick (nominal) extruded aluminum 6063-T52/T6 alloy. Blades spaced approximately 3" on center with architectural hidden mullions.

SUPPORTS: Shall incorporate rear angle 2" x 2" x 1/4" extruded aluminum to withstand windload of 20 PSF, approximately 90 mph wind. Supports vary as required, per wind load. Spaced approximately 60" on centers.

FINISH: Mill

OPTIONS

Variations - Mitered Corner, Post Corner, Hinged Access, and Cap Covers.

Finishes - Kynar, Baked Enamel, Clear and Color Anodize (Consult the factory for details.)

NOTES

1. "Maximum panel size should not exceed 60 sq. ft. or 120"W x 72"H. Louver sections larger than the factory maximum size will require field assembly of smaller sections.
2. Approximate shipping weight is 4.5 lbs./sq.ft.

SCREEN SIZES

Min Panel	Max Single Panel
12"W x 12"H	120"W x 72"H (60 sq.ft.)

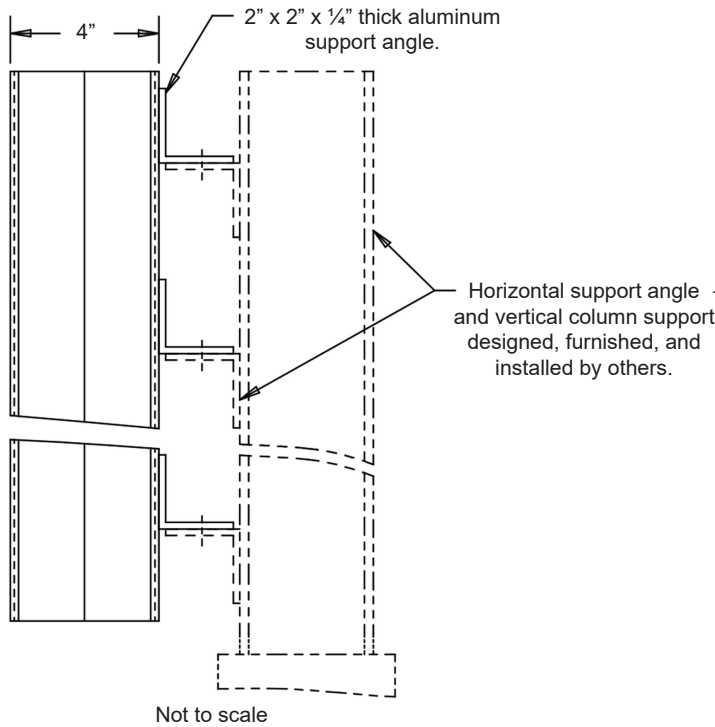
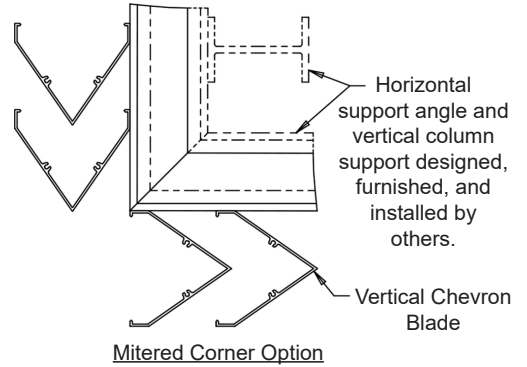

Item #	Qty	Height	Width	Mullion	Corner Type		Union Made
					Mitered	Post	
Arch. / Eng. :		EDR:		ECN:	Job:		
Contractor:		Date:		DWN:	DWG:		
Project:							

In the interest of product development, Louvers & Dampers reserves the right to make changes without notice.